

3 BASEMENT PLAN
 SCALE 1/4" = 1'-0"
 DEMOLITION

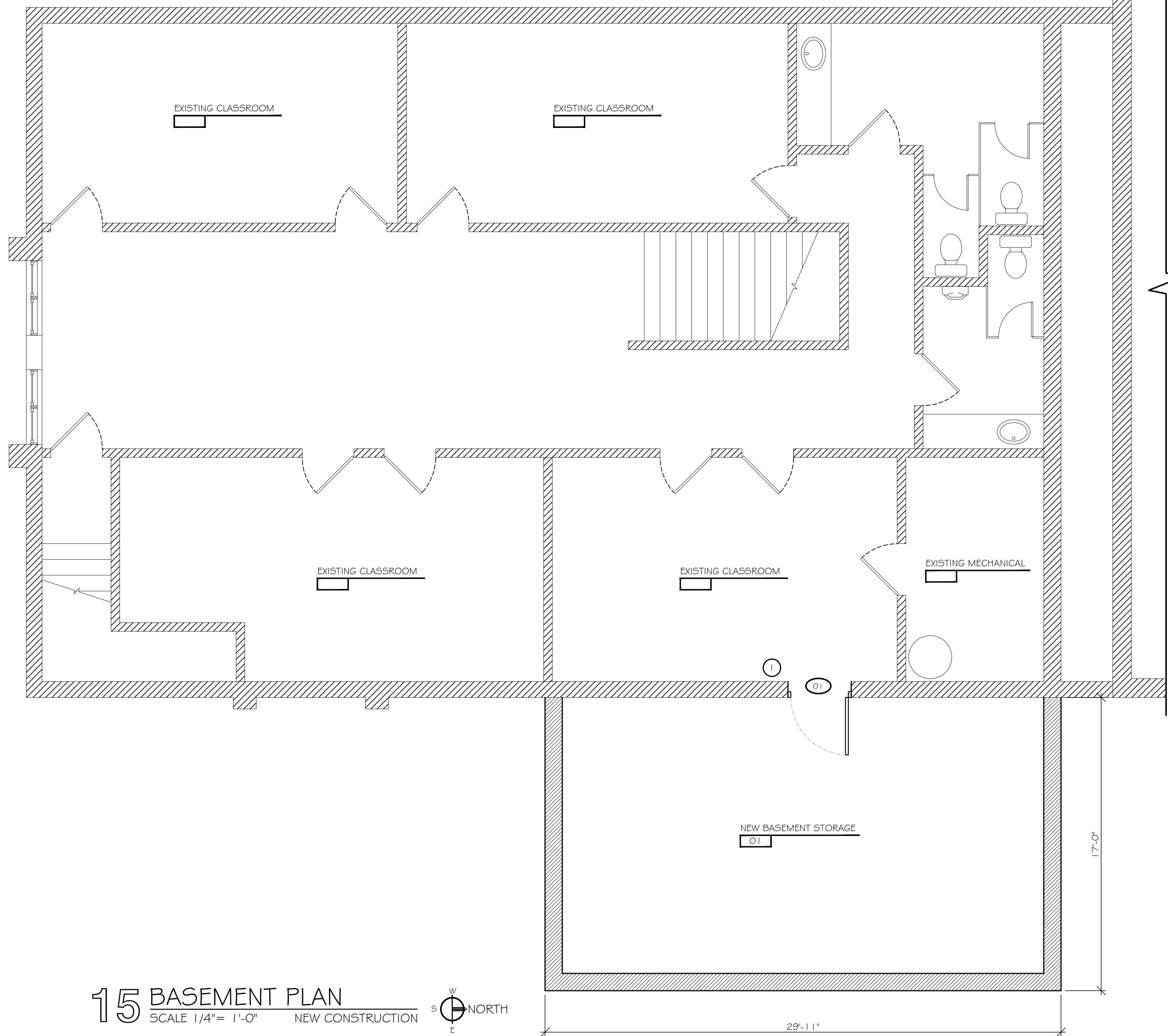

DEMOLITION PLAN NOTES

- ① SHORE EXISTING FLOOR PRIOR TO SAW-CUTTING EXISTING WALL. PROVIDE NEW STRUCTURAL SUPPORT.
- ② REMOVE PORTION OF FOUNDATION WALL FOR NEW BASEMENT STORAGE ENTRY. OPENING TO BE SIZED FOR NEW DOOR.



15 BASEMENT PLAN
 SCALE 1/4" = 1'-0"
 NEW CONSTRUCTION

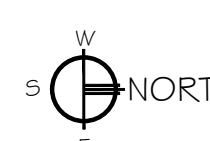

PLAN NOTES

- ① PATCH AND FINISH @ DEMOLITION TO MATCH ADJACENT FINISH. INFILL ABOVE NEW DOORS w/ STUD/GYP. BD. WALL, IF REQUIRED.
- ②

Verify all existing site conditions
 REVISIONS:

SHEET INDEX:
 BASEMENT ADDITION
 PLAN
 (ALSO BASEMENT
 DEMOLITION PLAN)

Copyright © 2017
 Idest House, Inc.
 DRAWN BY: [Signature] APPROVED BY: [Signature]
 RCN: [Signature] DATE: MAY 2, 2017

A201
 G667-BID_170511.dwg