

RM #	ROOM NAME	FLOOR		WALL FINISHES						CEILING FINISHES			REMARKS				
		SUBST	TYP.	BASE	N / NE	E / SE	S / SW	W / NW	TYPE	FINISH	HEIGHT						
100	VESTIBULE	EX	EX	WD	GB/GL	P-1	...	P-1	GB/GL	P-1	...	P-1	AT-1	VINYL	8'-0"	1 (CT-2)	
101	LOBBY	EX	EX	WD	GB/GL	P-1	...	P-1	GB/GL	P-1	...	P-1	AT-2	WD FRM	8'-8"	1 (CT-2)	
102	MARKET	C-RPR	CT-2	WD	GB/GL	P-1	...	P-1	GB/GL	P-1	...	P-1	WD GRD	5/V	8'-4"	1, 3	
103	COUNTER	EX	EPOXY	EPOXY	...	...	...	...	...	...	...	...	SOFFIT	GB/P	8'-0"	6	
104	DINING AREA	EX	EX	WD	...	P-1	...	P-1	GB	P-1	...	P-1	AT-2	WD FRM	8'-8"	1 (CT-2)	
105	MEETING AREA	EX	EX	WD	...	P-1	...	P-1	GB	P-1	...	P-1	AT-3	KNIFE	9'-6"	1 (CT-2), 4	
105a	STORAGE	EX	EX	VB	...	P-1	...	P-1	GB	P-1	...	P-1	...	...	...	...	
106	RAISED DINING	WD	WD	WD	GB	P-1	...	P-1	WD	5/V	WD	5/V	TRELLIS	5/V	9'-4"	...	
107	EAST CORRIDOR	EX	EX	WD	...	P-1	...	P-1	GB	P-1	...	P-1	...	...	...	1 (CT-2), 4	
108	ELECTRICAL	???	C?	UNFIN	VB	...	P-1	...	P-1	GB	P-1	GB	P-1	P-1	8'-0"	...	
109	CHEF'S TABLE	EX	CT-1	WD	GB/GL	P-1	...	P-1	GB/GL	P-1	GB/GL	P-1	AT-3	KNIFE	9'-6"	...	
110	KITCHEN	EX	EPOXY	EPOXY	GB	FRP	GB/GL	FRP	FRP/SS	...	FRP/SS	...	FRP/SS	AT-1	VINYL	8'-0"	2, 6
111	PICK-UP	EX	EPOXY	EPOXY	GB	FRP	GB/GL	FRP	GB	FRP	GB	FRP	AT-1	VINYL	8'-0"	5, 6	
112	KITCHEN CORRIDOR	C	EPOXY	EPOXY	GB	FRP	GB	FRP	GB	FRP	GB	FRP	AT-1	VINYL	8'-0"	5, 6	
113	DISHWASH	C	EPOXY	EPOXY	GB	FRP	GB	FRP	GB	FRP	GB	FRP	AT-1	VINYL	8'-0"	5, 6	
114	PREP KITCHEN	C	EPOXY	EPOXY	GB	FRP	GB	FRP	GB	FRP	GB	FRP	AT-1	VINYL	8'-0"	5, 6	
116	COOLER	C	S	...	...	...	...	...	...	...	...	...	...	...	8'-0"	...	
117	MEAT	C	S	...	...	...	...	...	...	...	...	...	...	...	8'-0"	...	
118	FREEZER	C	S	...	...	...	...	...	...	...	...	...	...	...	8'-0"	...	
120	SOUTH CORRIDOR	EX	EX	WD	...	P-1	...	P-1	GB	P-1	...	P-1	AT-1	VINYL	8'-0"	1 (CT-2)	
121	JANITOR	EX	CT-2	CT-2	GB	FRP	GB	P-1	GB	P-1	GB	FRP	AT-1	VINYL	8'-0"	...	
122	WOMEN	EX	EX	EX	...	...	...	...	...	...	...	...	AT-1	VINYL	8'-0"	1 (CT-3)	
123	MEN	EX	EX	EX	...	...	...	...	...	...	...	...	AT-1	VINYL	8'-0"	1 (CT-3)	
S-1	STAIR	WD	V-T	V-T	...	P-1	...	P-1	GB	P-1	...	P-1	...	...	OPEN	...	

**ABBREVIATIONS FOR ROOM FINISH SCHEDULE**

EX	EXISTING TO REMAIN	FINISH MATERIALS	SS	STAINLESS STEEL	
SUBST.	SUBSTRATE	AT-#	ACOUSTIC CEILING TILE	V-#	VINYL-SHEET FLOORING
...	EXISTING/ NONE / NA	CA-#	CARPET	VB-#	VINYL BASE
SUBSTRATE MATERIALS		CT-#	CERAMIC TILE	VCT-#	VINYL COMPOSITION TILE
C	CONCRETE	FRP	FIBER REINFORCED PLASTIC	V-T	VINYL TREAD
C-RPR	CONCRETE-REPAIR	P-#	PAINT	WD	WOOD-SOLID
CMU	CONCRETE MASONRY UNIT	RTR-#	RUBBER TREAD/RISERS	WV	WOOD-VENEER
GB	GYPSUM BOARD	S	SEALED	EPX	EPOXY COATING
GL	GLASS BOARD	S/V	STAIN/VARNISH		
WD	WOOD				
WS	WOOD SHEATHING				

**REMARKS FOR ROOM FINISH SCHEDULE**

- PATCH IN NEW TILE IN AREAS OF DAMAGE OR REMODELING
- STAINLESS STEEL (WALL PANEL AND CLAD COLUMN)
- EXISTING "CEILING" FAN TO BE RELOCATED INTO THIS AREA
- "WOOD" SHUTTERS ON BARN DOOR TYPE TRACKS
- STAINLESS STEEL CORNER GUARDS AT EXPOSED, OUTSIDE CORNERS
- ...
- ...

**2 ROOM FINISH SCHEDULE**  
NO SCALE

DOOR #	DOOR LOCATION	DOOR SIZE	MAT	TYPE	FRAME	GLASS	DETAILS	HARDWARE	FIRE RATE	REMARKS
100e	VESTIBULE	3'-0" x 8'-0"	ALUM	FG	ALUM 2	INSUL	-	-	-	...
100i	VESTIBULE	3'-0" x 8'-0"	ALUM	FG	ALUM 2	INSUL	-	-	2	...
101e	LOBBY	3'-0" x 8'-0"	ALUM	FG	ALUM 2	INSUL	-	-	1	...
101o	LOBBY - Overhead Door	8'-0" x 8'-0"	ALUM	PNL	ALUM 2	INSUL	-	-	8	...
105	MEETING AREA	(2) 2'-8" x 8'-0"	WD	PNL	WD DTL	-	-	-	-	1
105x	STORAGE	(2) 3'-0" x 6'-8"	WD	F	WD 2	-	-	-	6	3
107e	EAST CORRIDOR	3'-4" x 6'-8"	MTL	F	HM 2	INSUL	-	-	3	...
108	ELECTRICAL	3'-0" x 6'-8"	WD	F	HM 1	-	-	-	4	...
109r	CHEF'S TABLE (@ Corridor)	2'-4" x 6'-8"	WD	F	WD 2	-	-	-	7	4
110r	KITCHEN (to Chef's Table)	2'-4" x 6'-8"	WD	F	WD 2	-	-	-	7	4
112er	KITCHEN CORRIDOR	3'-4" x 7'-0"	HM	F	HM 1	INSUL	-	-	3	4
116	COOLER					INSUL	-	-	-	2
117	MEAT					INSUL	-	-	-	2
118	FREEZER					INSUL	-	-	-	2
120e	SOUTH CORRIDOR	3'-0" x 8'-0"	ALUM	FG	ALUM 2	INSUL	-	-	1	...
121	JANITOR	3'-0" x 6'-8"	WD	F	WD 1	-	-	-	4	...
122	WOMEN	3'-0" x 6'-8"	WD	F	WD 1	-	-	-	5	...
123	MEN	3'-0" x 6'-8"	WD	F	WD 1	-	-	-	5	...

**ABBREVIATIONS FOR DOOR SCHEDULE**

EX EXISTING TO REMAIN  
... NO FINISH INDICATED/NA

**MATERIALS**

HM	HOLLOW METAL
WD	WOOD
ALUM	ALUMINUM
...	...

**4 DOOR SCHEDULE**  
NO SCALE

**REMARKS FOR DOOR SCHEDULE**

- CUSTOM DOORS IN MOVEABLE WALL
- SPECIAL DOORS PART OF WALK-IN COOLER PACKAGE
- SALVAGE EXISTING DOORS; UPDATE WITH "BOARD" FACING
- DOOR IS SALVAGED FROM AN EXISTING LOCATION FOR USE
- ...
- ...
- ...

**1 1st (Main) FLOOR PLAN**  
1/8" = 1' - 0"

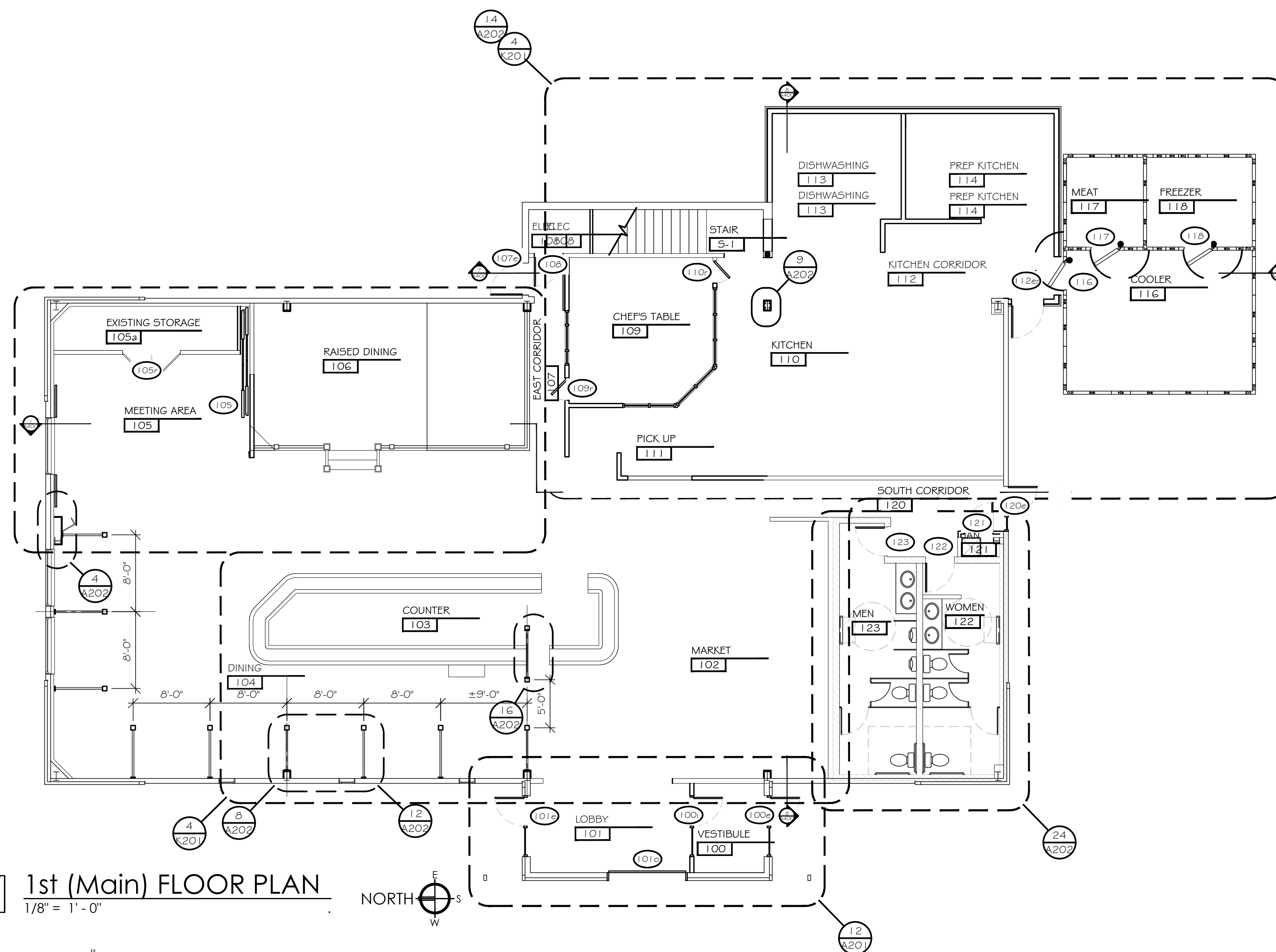

**12 VESTIBULE PLAN**  
1/4" = 1' - 0"

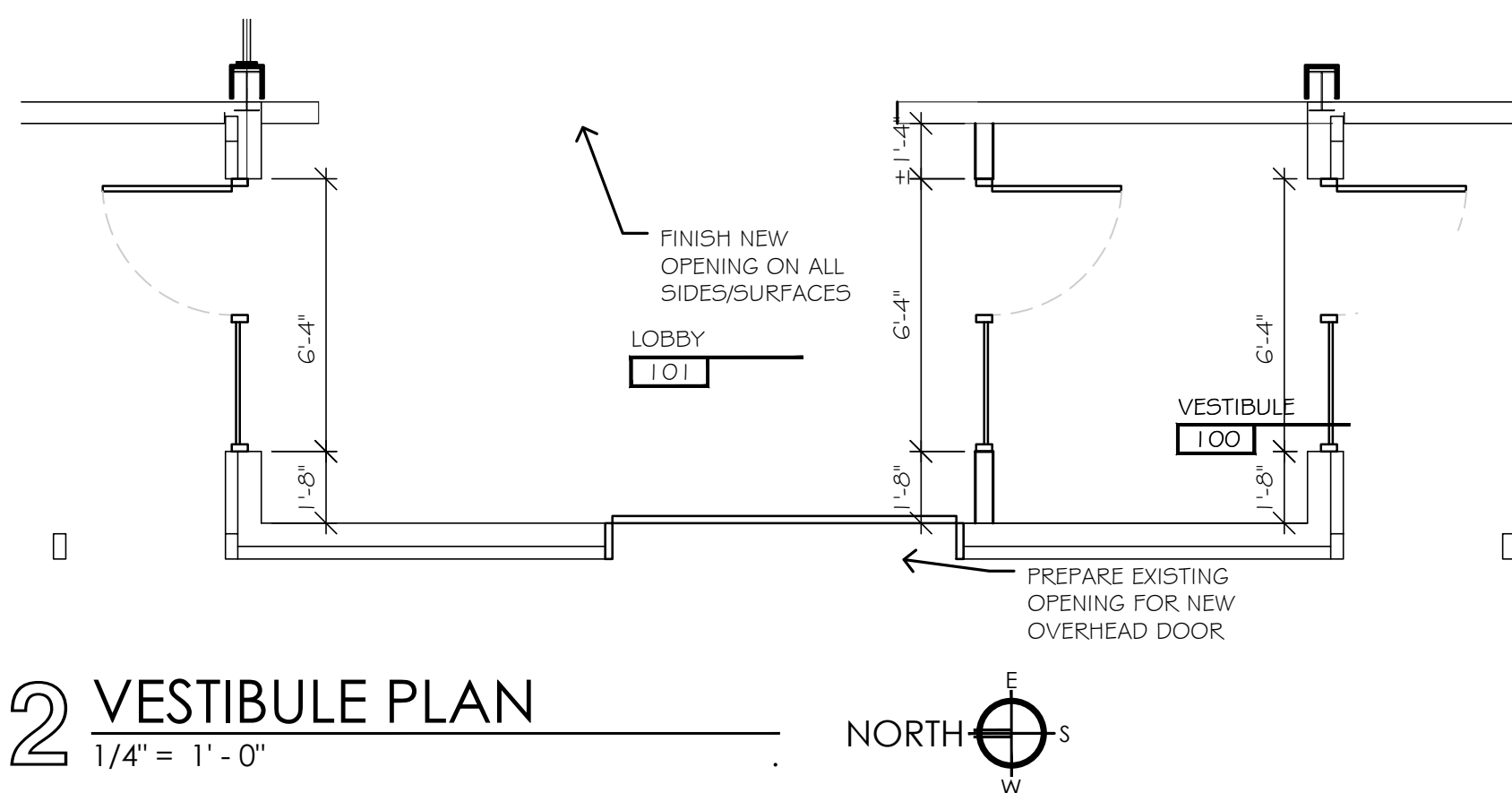

Verify all existing site conditions.  
REVISIONS:  
SCHEDULE #1 for DOOR HARDWARE and CT FLOOR

**SHEET INDEX:**  
1st FLOOR PLAN, SCHEDULES & DETAILS

DRAWN	APPROVD
DJR	of
MAY 22, 2018	
JUNE 11	